

FORM No 1.

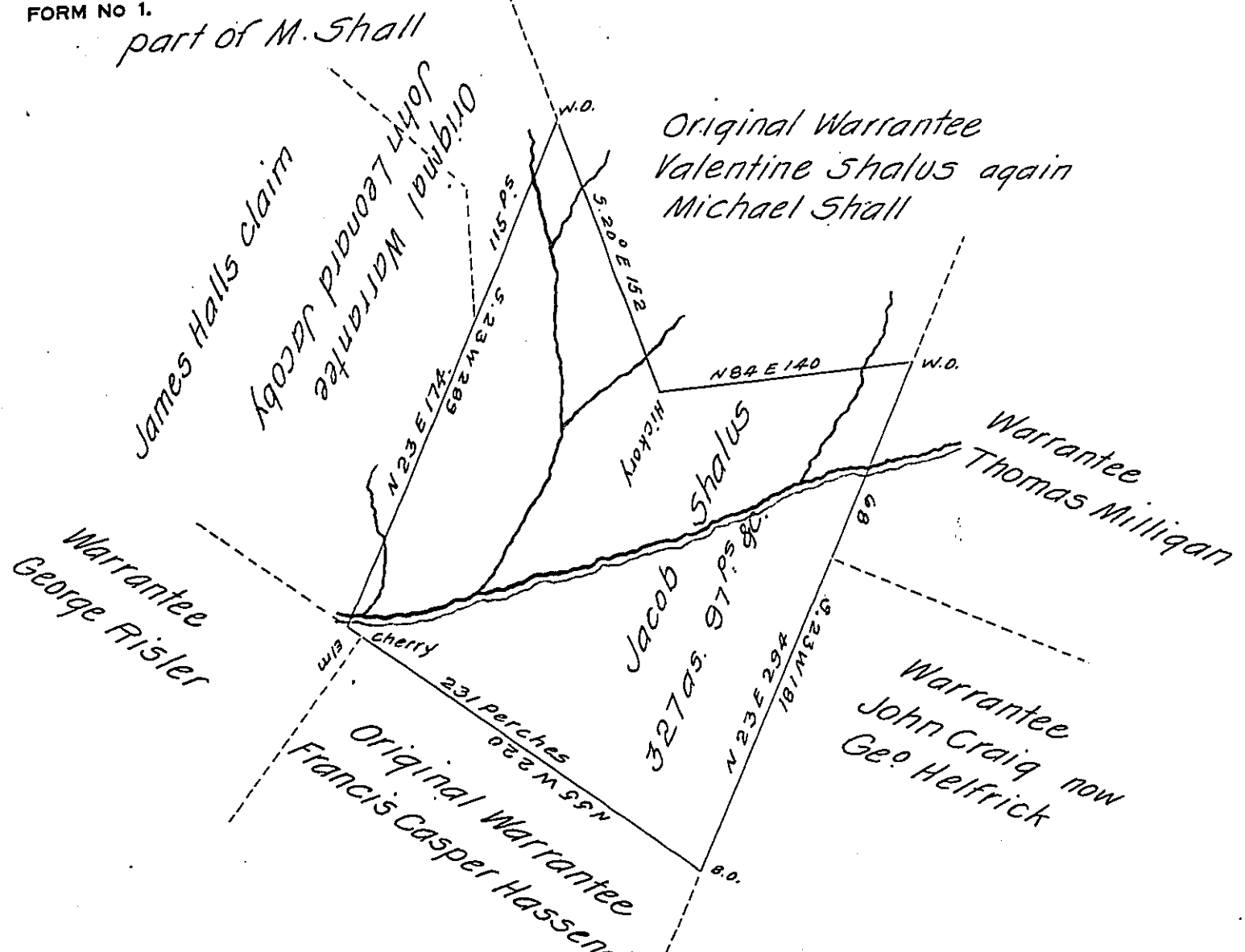

In pursuance of a Contract made with ~~the~~ the Board of Property dated the 19th of October 1827. I have examined the situation and boundaries of the above described tract of land and agreeable to the papers in this Office it appears to be the same tract of land which was first surveyed to Jacob Shalus on the 24th of Sept: 1776 in pursuance of a Warrant granted to the same dated the 7th of March 1775 and by endorsement on the back of the same is one of the Surveys of J. Vandever. which contains three hundred and twenty seven acres ninety seven perches and the Allowance of Six P. C^t 8c. Situate in Kittanning township Armstrong County. bounded as represented by the Diagram. But the same was afterwards surveyed to James Elder on the 3^d of Dec: 1788. by Warrant of the 8th of October 1788 and is in possession of tenants and Owners who claim under the letter title.

Jacob Spangler Esquire }
 Surveyor Gen. } Robert Richard
 D.S.

N.B. John King is one Owner of a part of the above described tract of

IN TESTIMONY that the above is a copy of the original remaining on file in the Department of Internal Affairs of Pennsylvania, made conformably to an Act of Assembly approved the 16th day of February, 1833, I have hereunto set my Hand and caused the Seal of said Department to be affixed at Harrisburg, this twenty third day of November 1908.

Henry Horvath
 Secretary of Internal Affairs.